

# KW1CGY10PDL0650E

## Product Details

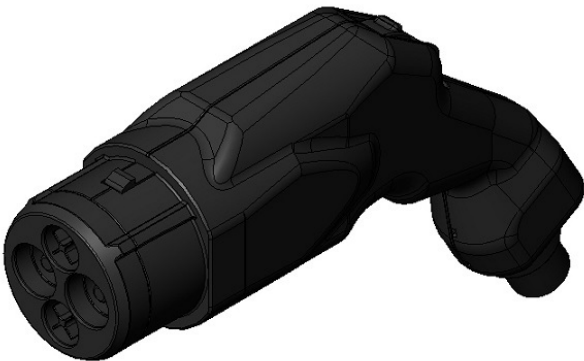

### Features

Electric vehicle quick charger connector, CE-Marking, Compliant with CHAdEMO Ver2.0, 150A, Charging and Discharging System Connector, Cable Length: 6, 500 mm

Part Number	KW1CGY10PDL0650E
Status	Active
Number of Positions	Power: 2 pos., 12V Power: 2 pos., Signal: 6 pos.
Rated Current	Power: 150 A max. (-30 deg.C to +40 deg.C), 12V: 6.4 A, Signal: 2 A
Rated Voltage	Power: DC 500 V, 12V Power: DC 16 V max., Signal: DC 16 V max.
Applicable Specifications	CHAdEMO Ver2.0
Connector Type	Quick Charging / Charging and Discharging System Connector for EV
Cable Length	6,500 mm
Shell Size	G
Contact Size	D
Dielectric Withstanding Voltage (1 minute)	A.C. 3,000 V
Durability	10000
Insertion Force	100 N max.
Operating Temperature Range	-30 deg. C to +50 deg. C
RoHS compliant	10 substances (2011/65/EU, (EU)2015/863)

REACH compliant	
Remarks	

**Notice**

1. The values specified in this web site are only for reference. The products and their specifications are subject to change without notice.  
Contact our sales staff for further information before considering or ordering any of our products.  
For purchase, a product specification must be agreed upon.
2. Please contact us if you are considering use involving a quality assurance program that you specify or that is peculiar to the industry. Also contact us regarding the details of use, usage, specification before considering or ordering any of our products.
3. Users are requested to provide protection circuits and redundancy circuits to ensure safety of the equipment, and sufficiently review the suitability of JAE's products to the equipment.