

# SF15W006S4BR2000

## Product Details

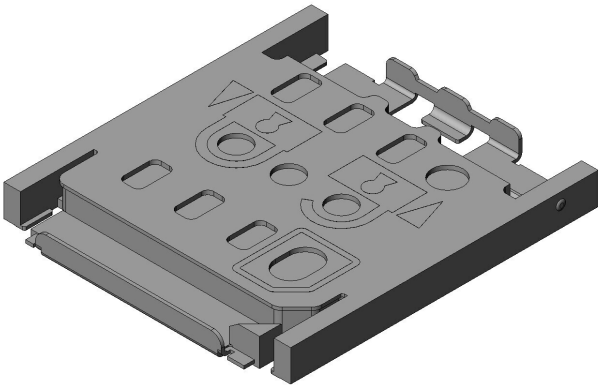

### Features

microSIM Card Connector, Hinge Type, Good EMI Performance, 6 pos., 1.55mm height, Hinge Type

Part Number	SF15W006S4BR2000
Status	Active
Number of Positions	6 pos.
Connector Type	Hinge type
PCB Mounting Style	Soldering (SMT)
PCB Retention Feature	Hold-down
PCB Mounted Height	1.55 mm
Body Length	15.60 mm
Body Breadth	13.95 mm
Material of Contact	Copper alloy
Finish of Contact in Connecting Area	Gold plating over Nickel
Finish of Contact in Terminal Area	Gold flash plating over Nickel
Material of Housing	Synthetic resin
Material of Cover Frame	Stainless steel

Ground Frame Material/ Finish (Terminal Area)	Copper alloy/ Gold flash plating over Nickel
Rated Current	0.5 A max.
Rated Voltage	10 V max.
Contact Resistance	200 milliohm max.
Insulation Resistance	100 megaohm min.
Dielectric Withstanding Voltage	AC 500 Vr.m.s.
Durability	1,500 times
Operating Temperature Range	-30 deg. C to +85 deg. C
Packaging Type	Embossed tape packaging
Quantity in The Standard Packaging	2,000 pieces/ reel
RoHS compliant	10 substances (2011/65/EU, (EU)2015/863)
REACH compliant	
Remarks	2,000 個/リール

**Notice**

1. The values specified in this web site are only for reference. The products and their specifications are subject to change without notice. Contact our sales staff for further information before considering or ordering any of our products.  
For purchase, a product specification must be agreed upon.
2. Users are requested to provide protection circuits and redundancy circuits to ensure safety of the equipment, and sufficiently review the suitability of JAE's products to the equipment.
3. The products presented in this web site are designed for the uses recommended below.  
We strongly suggest you contact our sales staff when considering use of any of the products in any other way than the recommended applications or for a specific use that requires an extremely high reliability.  
(1) Applications that require consultation:
  - \* Please contact us if you are considering use involving a quality assurance program that you specify or that is peculiar to the industry, such as:  
Automotive electrical components, train control, telecommunications devices (mainline), traffic light control, electric power, combustion control, fire prevention or security systems,

disaster evention equipment, etc.

\* We may separately give you our support with a quality assurance program that you specify, when you think of a use such as :

Aviation or space equipment, submarine repeaters, nuclear power control systems, medical equipment for life support, etc.

(2) Recommended applications include:

\* Computers, office appliances, telecommunications devices (terminals, mobile units), measuring equipment, audiovisual equipment, home electric appliances, factory automation equipment, etc