

WD2M144WB2R300

Product Details

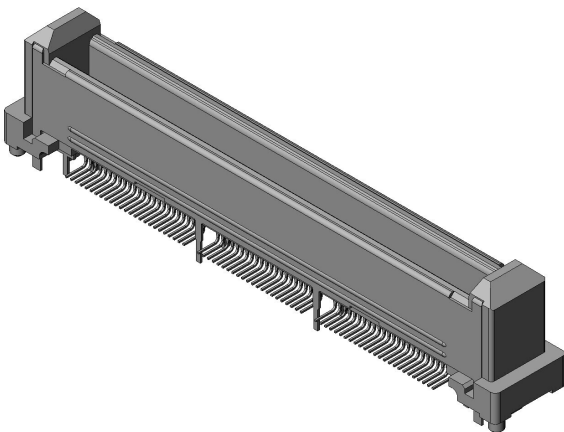

Features

Docking connector compatible to PCI Express, 144 pos. (Signal terminal, +4 Power terminals), Plug

Part Number	WD2M144WB2R300
Status	Active
Number of Positions	144 pos. (Signal terminal, +4 Power terminals)
Contact Pitch (mm)	0.5
Rated Current (A)	0.5 (Signal)/ 10 (Power)
Connector Type	Plug
Connector Style	Straight
Number of Rows	2
PCB Mounting Method	Soldering (SMT)
Material of Contact	Copper alloy
Finish of Contact in Connecting Area	Gold plating over Nickel
Material of Insulator	Glass filled LCP
PCB Mounted Height (mm)	10.5
Body Length (mm)	50.5
Body Breadth (mm)	7.4

Body Height (mm)	10.5
Operating Temperature Range (deg. C)	-40 to +85
Mating Cycles (times)	10000
Packaging Type	Embossed tape packaging
Quantity in The Standard Packaging (pieces)	300 pieces/reel
RoHS compliant	10 substances (2011/65/EU, (EU)2015/863)
REACH compliant	235 substances (14/06/2023)
Combination	WD2F144WB3R300 WD2F144WB1R300 WD2F144WB2R250 WD2F144WB4R400 WD2F144WB5R400
Remarks	Mating angle:0

Notice

1. The values specified in this web site are only for reference. The products and their specifications are subject to change without notice. Contact our sales staff for further information before considering or ordering any of our products.
For purchase, a product specification must be agreed upon.
2. Users are requested to provide protection circuits and redundancy circuits to ensure safety of the equipment, and sufficiently review the suitability of JAE's products to the equipment.
3. The products presented in this web site are designed for the uses recommended below.
We strongly suggest you contact our sales staff when considering use of any of the products in any other way than the recommended applications or for a specific use that requires an extremely high reliability.
 - (1) Applications that require consultation:
 - * Please contact us if you are considering use involving a quality assurance program that you specify or that is peculiar to the industry, such as:
Automotive electrical components, train control, telecommunications devices (mainline), traffic light control, electric power, combustion control, fire prevention or security systems, disaster evention equipment, etc.
 - * We may separately give you our support with a quality assurance program that you specify, when you think of a use such as :

Aviation or space equipment, submarine repeaters, nuclear power control systems, medical equipment for life support, etc.

(2) Recommended applications include:

* Computers, office appliances, telecommunications devices (terminals, mobile units), measuring equipment, audiovisual equipment, home electric appliances, factory automation equipment, etc