

WP86SD-P080VA1-R20000

Product Details

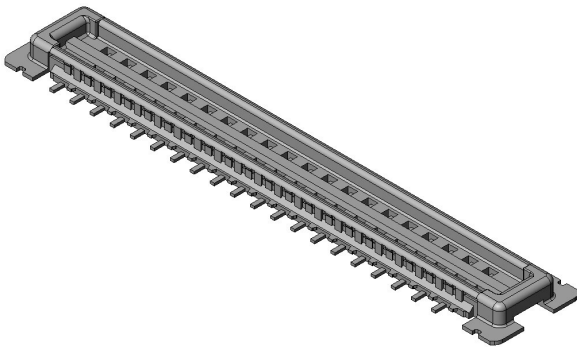

Features

Board-to-Board (FPC) Connector, 80 pos., 0.25mm contact pitch / 0.5mm soldering pitch, 0.6mm stacking height, SMT, with power terminals, Plug

Part Number	WP86SD-P080VA1-R20000
Status	Active
Number of Positions	80 positions (+2 power)
Pitch	Contact Area 0.25 mm Soldering Area: 0.5 mm
Rated Current (AC, DC per pos.)	Signal Terminal: 0.3 A, Power Terminal: 8.0 A
Rated Voltage (AC, DC)	50 V
Applicable Specifications	
Waterproof/ Non-waterproof	Non-waterproof
Applications	Smartphones, smart glasses, tablet and laptop PCs, gaming terminals, digital cameras, AR/VR headsets, other portable devices
Connector Type	Plug
Connector Style	Straight
Number of Rows	Contact Area: 2 rows, Soldering Area: 4 rows
PCB Mounting Method	Soldering (SMT)
Material of Contact	Copper alloy

Finish of Contact in Connecting Area	Gold plating
Finish of Contact in PCB Mounting Area	Gold plating
Material of Insulator	Heat-resistant plastic
PCB Mounted Height	0.53 m m
PCB Boardlock Feature	Hold-down (double as power contact)
Body Length	12.3 mm
Body Breadth	2.2 mm
Total Insertion Force	66 N max.
Total Extraction Force	6 N min.
Operating Temperature Range	-40 Deg. C to +85 Deg. C
Durability	30 mating cycles
Packaging Type	Embossed tape packaging
Quantity in The Standard Packaging	20,000 pieces/reel
RoHS compliant	10 substances (2011/65/EU, (EU)2015/863)
REACH compliant	235 substances (14/06/2023)

Notice

1. The values specified in this web site are only for reference. The products and their specifications are subject to change without notice. Contact our sales staff for further information before considering or ordering any of our products.
For purchase, a product specification must be agreed upon.
2. Users are requested to provide protection circuits and redundancy circuits to ensure safety of the equipment, and sufficiently review the suitability of JAE's products to the equipment.
3. The products presented in this web site are designed for the uses recommended below.
We strongly suggest you contact our sales staff when considering use of any of the products in any other way than the recommended applications or for a specific use that requires an extremely high reliability.
(1) Applications that require consultation:

* Please contact us if you are considering use involving a quality assurance program that you specify or that is peculiar to the industry, such as:

Automotive electrical components, train control, telecommunications devices (mainline), traffic light control, electric power, combustion control, fire prevention or security systems, disaster evention equipment, etc.

* We may separately give you our support with a quality assurance program that you specify, when you think of a use such as :

Aviation or space equipment, submarine repeaters, nuclear power control systems, medical equipment for life support, etc.

(2) Recommended applications include:

* Computers, office appliances, telecommunications devices (terminals, mobile units), measuring equipment, audiovisual equipment, home electric appliances, factory automation equipment, etc