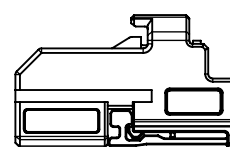
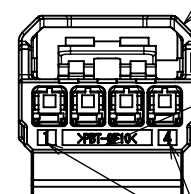

図面番号(DRAWING NO.) SJ123030

SOCKET TERMINAL (MX80S08K※F1)
ソケット端子 (MX80S08K※F1)

This diagram shows a cross-section of a socket terminal assembly. A cable with multiple conductors is inserted into a multi-pin connector. The conductors are shown passing through the connector housing and making contact with internal terminals. The diagram is a technical line drawing with hatching used to indicate different materials or cross-sections of the components.

[illegible]

TERMINAL CAVITY NO. MARKING
端子孔No. の刻印

This isometric view shows the front of the device. It features a large rectangular display screen at the top. Below the screen is a horizontal row of four square buttons. At the bottom of the front face, there is a wide, recessed area containing several horizontal slots, likely for ventilation or cable management.

FIG. 1 COUNTER-PART: SJ123035
図1. かん合相手: SJ123035

MX81A004SF1

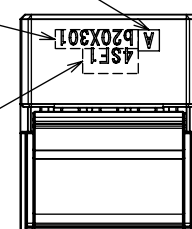

Technical drawing of the rear view of the seat assembly. The drawing shows the backrest and base. Dimensions are indicated as $(\varnothing 13.5)$ for the width and $(\varnothing 15.5)$ for the depth.

△△注3. 本製品はコアサイズ：0.13～1.0sq の電線を適用できる。